

TECHNICAL DATA

outer diameter measuring tube	5,5mm *1
inner diameter measuring tube	4,2mm *1

MISCELLANEOUS

Scope of delivery Halteclip für Fühler Ø4mm 1.4301/1.4310, Halteclip nur mit Werkzeug wieder lösbar *1

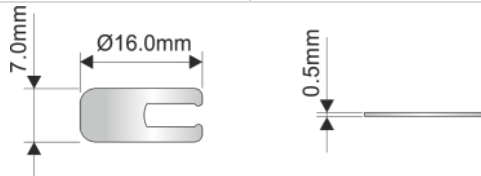

IN VERWENDUNG MIT

TP1133

TYPE KEY CONFIGURATION

Pos.:	Physical characteristics	Key	Characteristic
1	material measuring tube	A0	CuZn39Pb3 (CW614N) *1
		A1	CU SP - CW114G *1

EXISTING CONFIGURATIONS

Type	Order number	Item number	Old order number
------	--------------	-------------	------------------

REMARKS

measured in water 70°C, 0,04m/sec
 *1 measured in water 70°C, 0,04m/sec

We reserve the right to make technical modifications and correction at any time without prior notice!
 This version of the data / type sheet is a translation by a partner. We assume no liability for translation errors. If the translation contains errors or ambiguities, the German version of the data / type sheet is to be used.

REVISION

Version	Effective from	Comment
1.0	19.05.2017 10:55:17	Typenblatt angelegt